

# IPC-603MB

## 2U 3-Slot Rackmount Chassis for ATX/ MicroATX Motherboard with Front I/O



### Features

- The best embedded computing system for machinery applications
- Streamlined in-chassis airflow design supporting LGA775 Pentium® 4 processor up to 3.8 GHz with suggested CPU cooler
- All I/O interfaces are in the front
- Shock resistant disk drive bay design to hold one slim CD-ROM and one internal 3.5" HDD
- Equipped with 1U-high 300 W ATX PFC power supply
- Easy-to-replace air filters



### Specifications

Drive Bay	Slim Optical Disk Drive	Front-accessible	Internal
	3.5"	1	-
Cooling	Fan	2 (47 CFM each)	-
	Air Filters	3 (85 x 80 mm)	1
Miscellaneous	Notification LEDs	Power & HDD activity	
Environment	Temperature	Operating 0 ~ 40° C (32 ~ 104° F)	Non-Operating -20 ~ 60° C (-4 ~ 140° F)
	Humidity	10 ~ 85% @ 40° C, non-condensing	10 ~ 95% @ 40° C, non-condensing
	Vibration (5 ~ 500 Hz)	1 Grms	2 G
	Shock	10 G (with 11 ms duration, half sine wave)	30 G
	Physical Characteristics	Dimensions (W x H x D)	482 x 88 x 310 mm (19" x 3.46" x 12.2")
	Weight	6.4 kg (14.1 lb)	

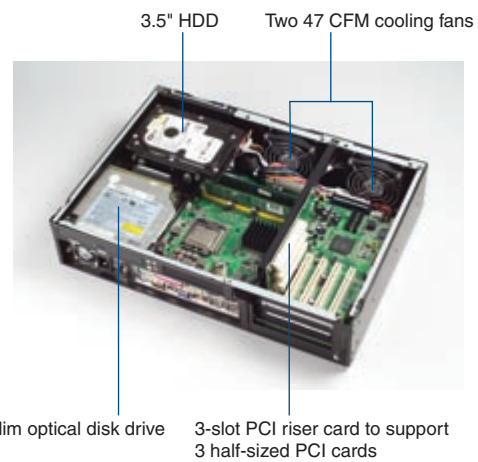
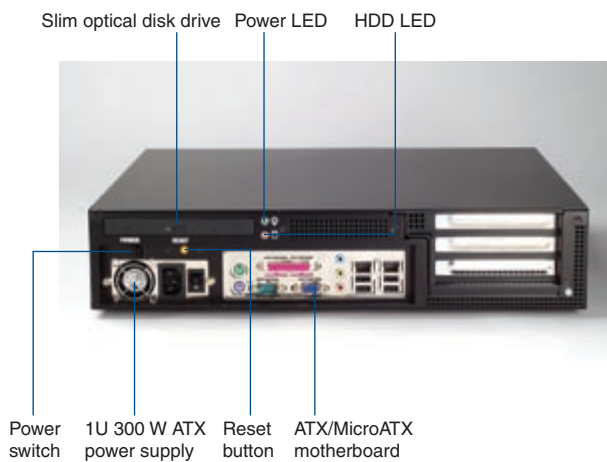

## Dimensions

Unit: mm (inch)

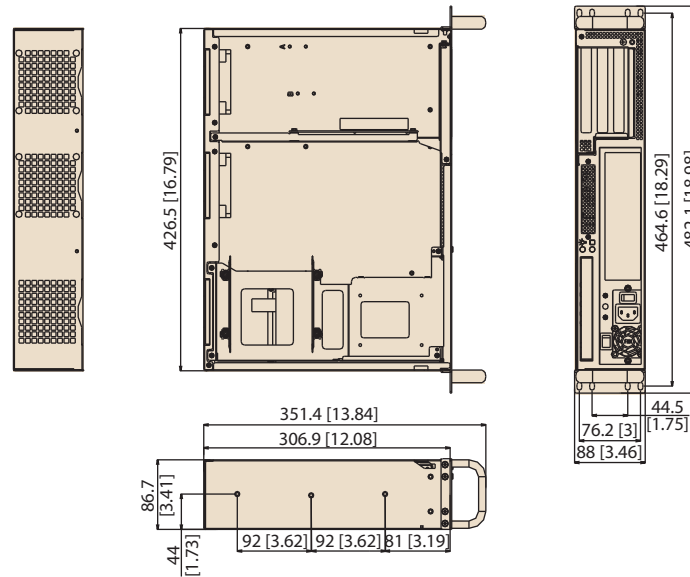

## Power Supply

Part Number	Watt	Input	Output	Specifications		
				Mini-load	Safety	MTBF
1757000160G (ATX, PFC)	300 W	AC 100 ~ 240 V (full range)	+5 V @ 25 A, +3.3 V @ 14 A +12 V @ 16 A, -12 V @ 1 A -5 V @ 0.5 A, +5 Vsb @ 2 A	+5 V @ 3 A, +12 V @ 2 A -5 V @ 0.05 A, -12 V @ 0.05 A +3.3 V @ 1 A, +5 Vsb @ 0.1 A	UL/TUV/CB/CCC	100,000 hours @ 25° C

## Accessories

Part Number	Description
96SCOM-24X8X-TE-B1	Black slim 24X/8X/24X DVDRW-ROM
96SCD-24X-I-OD-B	Black slim 24X CD-ROM
1750000257	2U-high Socket 478 P4 CPU cooler up to 3.2 GHz (89 W)
1750000332	2U-high LGA775 P4 CPU cooler up to 3.8 GHz
9662603000E	Fan 80 x 80 x 25 mm
1990001176	Fan filter 80 x 85 x 5 mm

## Ordering Information

Part Number	Power Supply	Motherboard	Regulation
IPC-603MB0-00XE	Without power supply, with ATX switch	-	-
IPC-603MB0-30ZE	1757000160G	-	CE

## Riser Card Options

Model Name	Interface	Expansion Slot	Motherboard
AIMB-R4301-03A1E	PCIe x4	Three PCIe x1	762/764/554/556, 762 & 554 only support one PCIe x1 (the lowest slot)
AIMB-R430P-03A1E	PCIe x4	Three PCI	AIMB-762/764/554/556
AIMB-R431F-21A1E	PCIe x4	One PCIe x16 + two PCIe x1	762 & 554 support only one PCIe x1 (the lowest slot) except one PCIe x16 AIMB-740/742/744/750/760/552/560; AIMB-542 only support one PCI (the lowest slot)
AIMB-RP30P-03A1E	PCI	Three PCI	AIMB-763/562/564
AIMB-RP3PF-21A1E	PCI	One PCIe x16 + two PCI	AIMB-763/562/564
AIMB-RH31P-12A1E	PCI+ PCIe x1	Two PCI + one PCIe x1	AIMB-760

\* The riser cards are specially designed to support all Advantech AIMB series motherboards.